

4

3

2

1

REVISIONS			
REV.	DESCRIPTION	DATE	APPROVED
X1	OL	07/21/25	K.LE

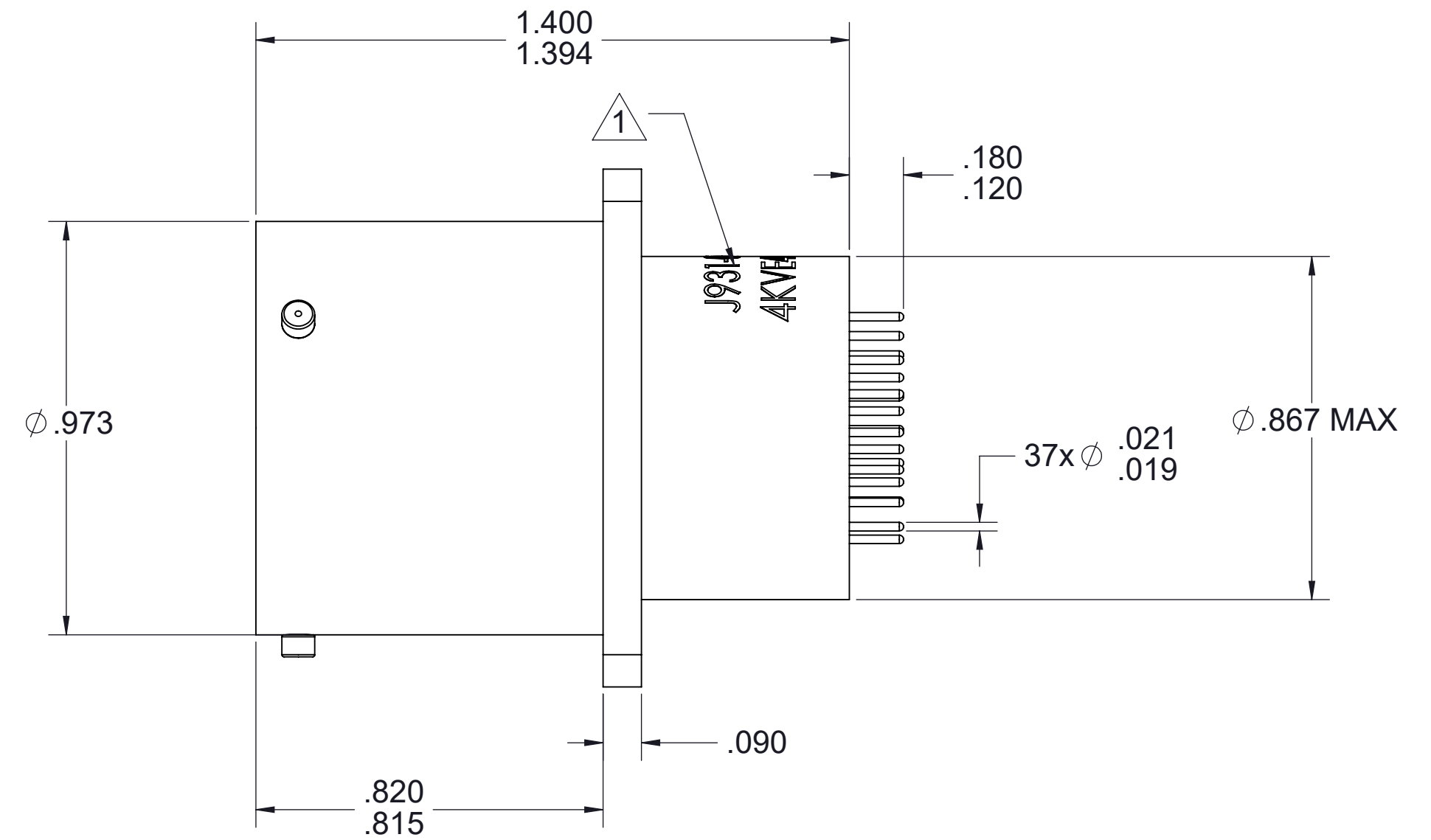
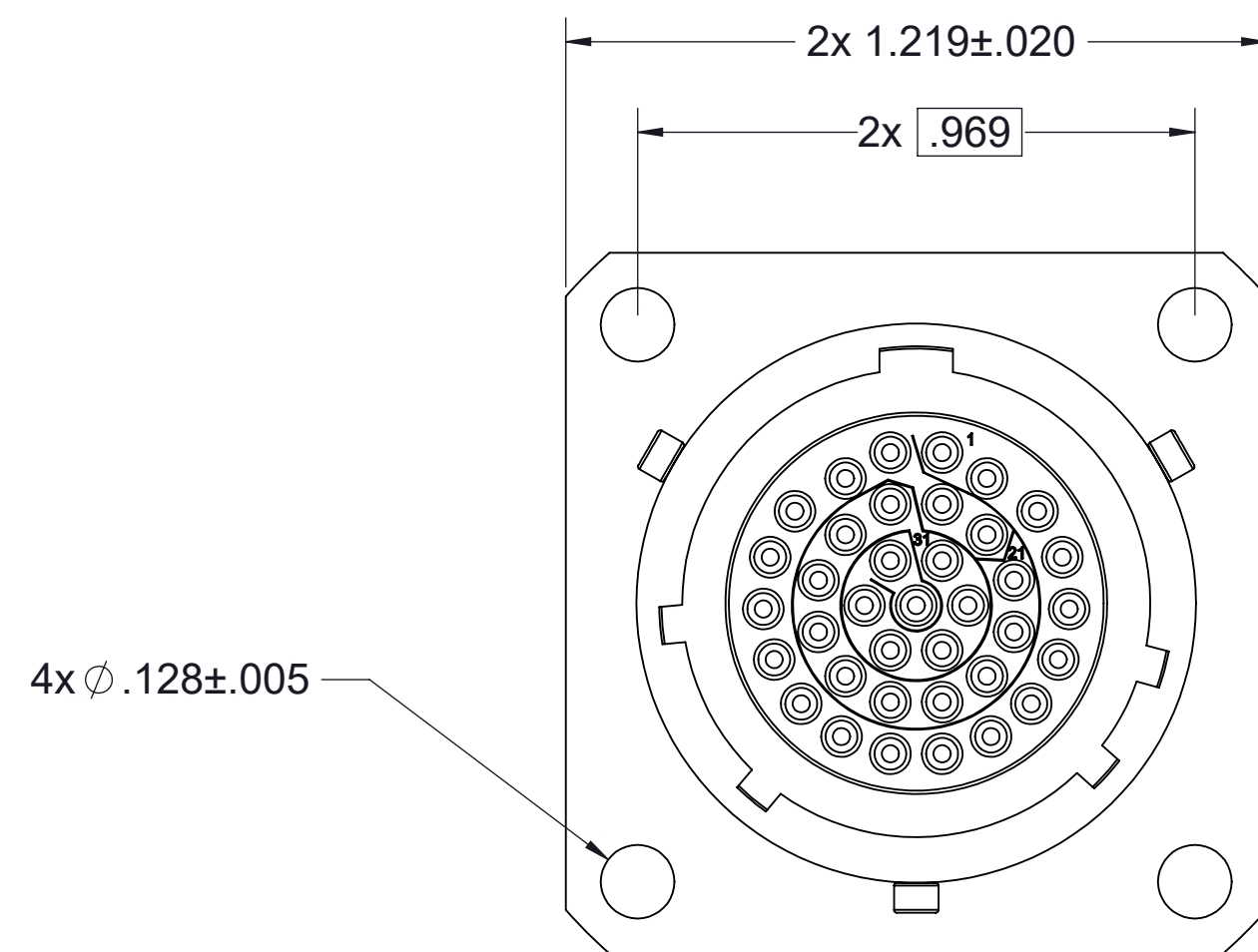

**MATERIAL AND FINISH:**

SHELL: ALUMINUM ALLOY 6061-T6511 PER ASTM-B221  
FINISH: ELECTROLESS NICKEL PLATING.

CONTACT: COPPER ALLOY PER SAE-AS39029.  
FINISH: GOLD PLATED.

CAPACITORS: CERAMIC, PLANAR.

INSULATOR: EPOXY GLASS LAMINATE PER MIL-DTL-38999.

INTERFACIAL SEAL: FLUOROSILICONE PER MIL-DTL-38999.

GROUND SPRING: BERYLLIUM COPPER, SILVER PLATED.

FERRITE: NICKEL ZINC.

SOLDER PREFORM: IDIUM SOLDER ALLOY, 50Pb/50In.

POTTING: EPOXY 2850FT/CAT9

**ELECTRICAL:**

PL FILTER

A. CAPACITANCE: ALL PINS TO BE 32,000-45,000 pF

B. I.R.: 5000 MEGOHMS MIN AT 100 VDC.

C. D.W.V.: 100 VDC, 2 SECONDS MIN DWELL TIME.

D. ATTENUATION: PER MIL-STD-220 AT 25°C

8 dB MIN AT 1 MHz

20 dB MIN AT 5 MHz

40 dB MIN AT 10 MHz

60 dB MIN AT 100 MHz

62 dB MIN AT 500-1000 MHz

**MECHANICAL:**

ALL INTERFACE DIMENSIONS PER MIL-DTL-38999.

INSERT ARRANGEMENT 15-35 PER MIL-STD-1560 PIN ENGAGEMENT.

1 MARKING: MARK WITH "J991PPDO35APAN"  
MFG CODE DATE CODE  
IN LOCATION SHOWN

**ENVIRONMENTAL:**

TEMPERATURE RANGE: -55°C TO +125°C.

ENVIRONMENTAL TESTING PER MIL-DTL-38999 AVAILABLE UPON REQUEST.

**NOTES:**

1. THESE CHARACTERISTICS ARE TYPICAL, AND FOR REFERENCE.

2. FOR QUESTIONS PLEASE CONTACT SALES@AMPHENOLCDI.COM

THE INFORMATION CONTAINED HEREIN IS PROPRIETARY TO AMPHENOL. AND SHALL IN NO WAY BE REPRODUCED OR DISCLOSED IN WHOLE OR IN PART OR USED FOR ANY DESIGN OR MANUFACTURE EXCEPT WHEN SUCH USER POSSESSES DIRECT, WRITTEN AUTHORIZATION FROM AMPHENOL.

DIMENSIONS ARE IN INCHES ± TOLERANCES UNLESS OTHERWISE NOTED		-		-		-	
.XX ± 0.005"	ANGULAR 1°	<b>MATERIAL</b>		<b>SPECIFICATION</b>		<b>PROCUREMENT</b>	
.XXX ± 0.003"		APPROVAL	INITIALS	DATE	Amphenol		12900 Alondra Blvd. Cerritos, CA 90703
		DRAWN BY	K.LE	07/21/25	TITLE		CONN. 38999I, 15-35, PIN/PC, "N" PLZN, CAD
		CHECKED BY	XXX	XX/XX/XXXX	SCALE		3:1
		TEST ENG	XXX	XX/XX/XXXX	SUB-DIRECTORY/		XXXXX
		QUALITY	XXX	XX/XX/XXXX	SHEET		1 of 1
		DESIGN ENG	XXX	XX/XX/XXXX	DRAWING NO.		OL_J991PPDO35APAN
		MFG ENG	XXX	XX/XX/XXXX	CAGE CODE	30990	REV. X1
		ECO APPRV	XXX	XX/XX/XXXX	DRAWING NO.		OL_J991PPDO35APAN