

4

3

2

1

REVISIONS			
REV.	DESCRIPTION	DATE	APPROVED
X1	OL	07/28/25	K.LE

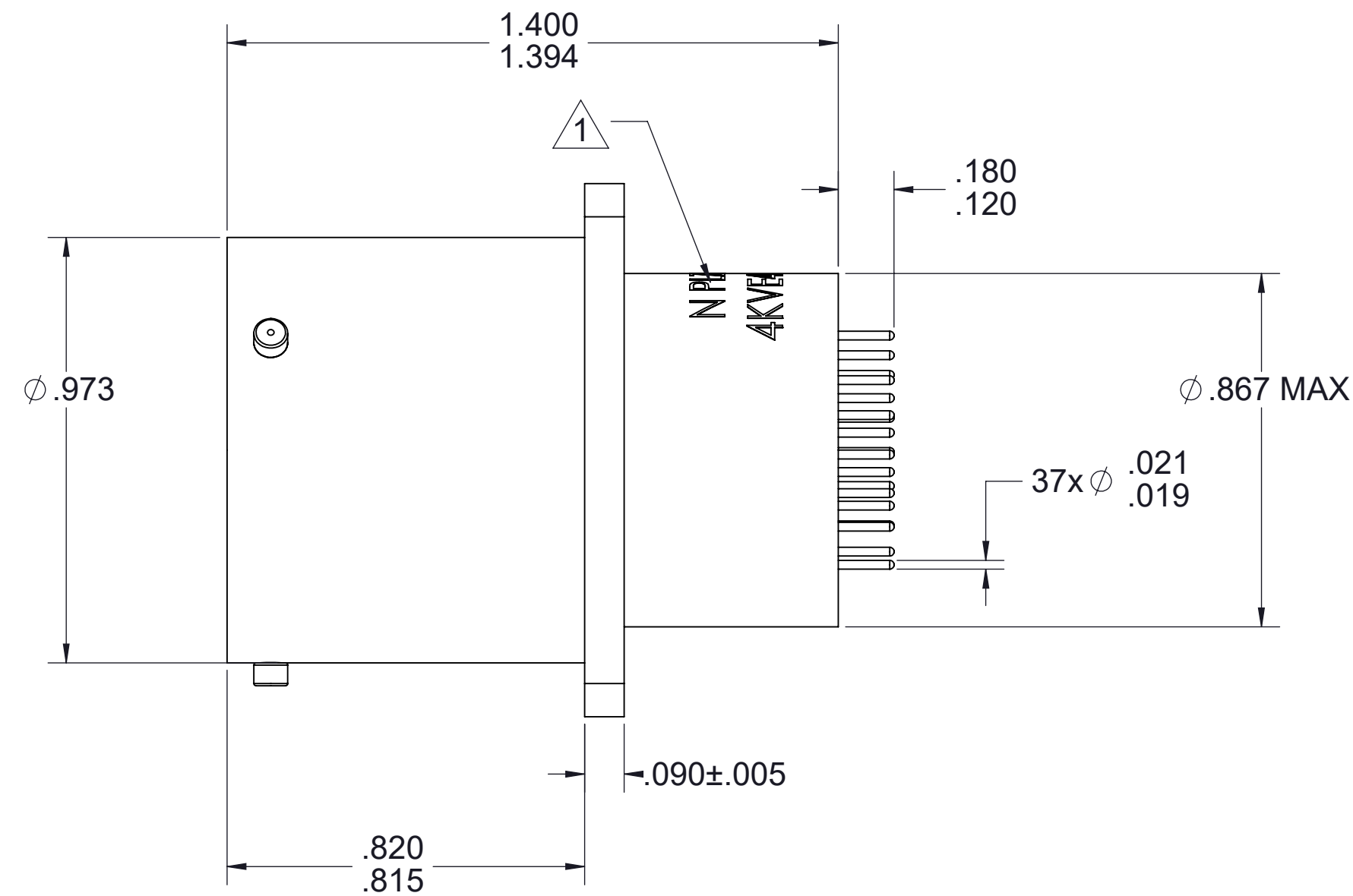
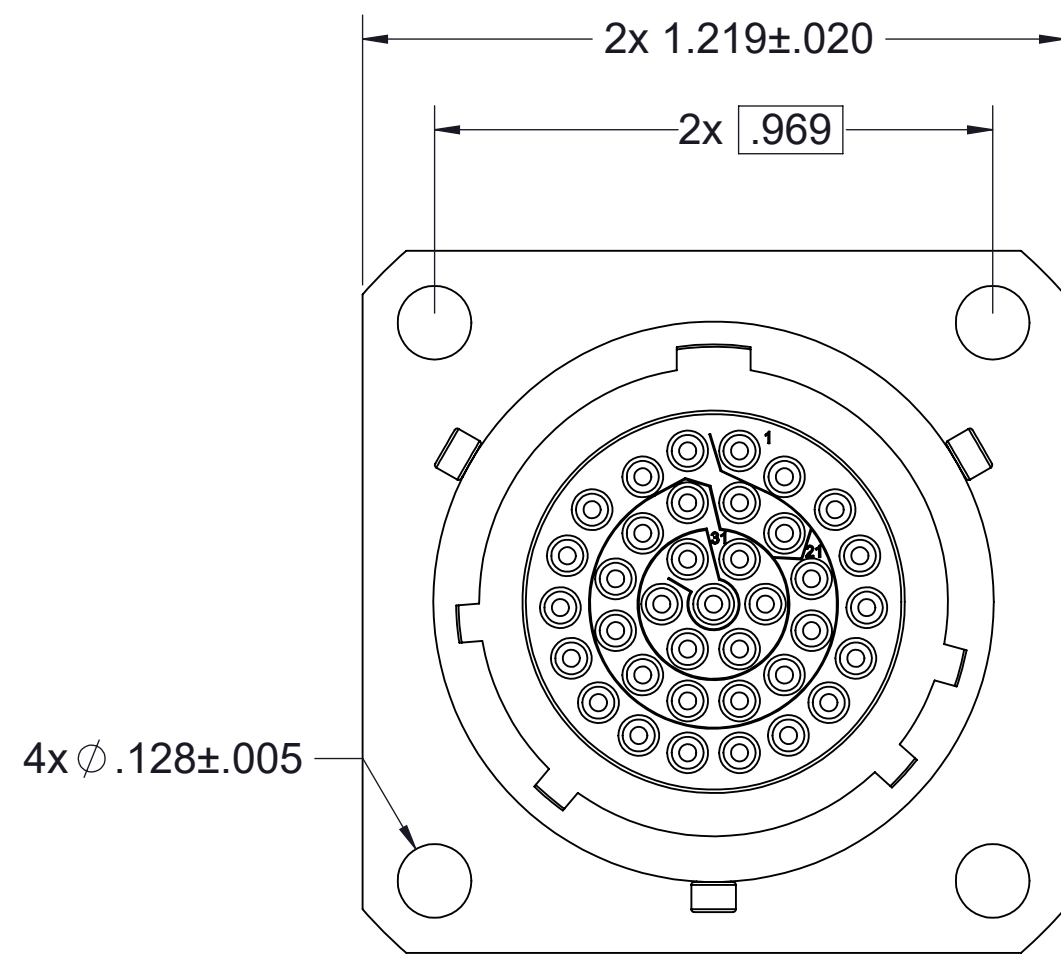

MATERIAL AND FINISH:

SHELL: ALUMINUM ALLOY 6061-T6511 PER ASTM-B221
FINISH: OLIVE DRAB CADMIUM PLATE.

CONTACT: COPPER ALLOY PER SAE-AS39029.
FINISH: GOLD PLATED.

CAPACITORS: CERAMIC, PLANAR.

INSULATOR: EPOXY GLASS LAMINATE PER MIL-DTL-38999.

INTERFACIAL SEAL: FLUROSILICONE PER MIL-DTL-38999.

GROUND SPRING: BERYLLIUM COPPER, SILVER PLATED.

FERRITE: NICKEL ZINC.

SOLDER PREFORM: IDIUM SOLDER ALLOY, 50Pb/50In.

POTTING: EPOXY 2850FT/CAT9

ELECTRICAL:

PM FILTER

A. CAPACITANCE: ALL PINS TO BE 8,000-12,000 pF

B. I.R.: 5000 MEGOHMS MIN AT 500 VDC.

C. D.W.V.: 500VDC, 2 SECONDS MIN DWELL TIME.

D. ATTENUATION: PER MIL-STD-220 AT 25°C

2 dB MIN AT 1 MHz

10 dB MIN AT 5 MHz

18 dB MIN AT 10 MHz

60 dB MIN AT 100 MHz

62 dB MIN AT 500-1000 MHz

MECHANICAL:

ALL INTERFACE DIMENSIONS PER MIL-DTL-38999.

INSERT ARRANGEMENT 15-35 PER MIL-STD-1560 PIN ENGAGEMENT.

1 MARKING: MARK WITH "J991PPDO35BPAN"
MFG CODE DATE CODE
IN LOCATION SHOWN

ENVIRONMENTAL:

TEMPERATURE RANGE: -55°C TO +125°C.

ENVIRONMENTAL TESTING PER MIL-DTL-38999 AVAILABLE UPON REQUEST.

NOTES:

- THESE CHARACTERISTICS ARE TYPICAL, AND FOR REFERENCE.
- FOR QUESTIONS PLEASE CONTACT SALES@AMPHENOLCDI.COM

THE INFORMATION CONTAINED HEREIN IS PROPRIETARY TO AMPHENOL. AND SHALL IN NO WAY BE REPRODUCED OR DISCLOSED IN WHOLE OR IN PART OR USED FOR ANY DESIGN OR MANUFACTURE EXCEPT WHEN SUCH USER POSSESSES DIRECT, WRITTEN AUTHORIZATION FROM AMPHENOL.

DIMENSIONS ARE IN INCHES ± TOLERANCES UNLESS OTHERWISE NOTED		-		-		-	
.XX ± 0.005"	ANGULAR 1°	MATERIAL		SPECIFICATION		PROCUREMENT	
.XXX ± 0.003"		APPROVAL	INITIALS	DATE	12900 Alondra Blvd. Cerritos, CA 90703		
		DRAWN BY	K.LE	07/28/25	Amphenol		
		CHECKED BY	XXX	XX/XX/XXXX	TITLE		
		TEST ENG	XXX	XX/XX/XXXX	CONN., 38999I/15-35 PIN/P.C PI		
		QUALITY	XXX	XX/XX/XXXX	FILTER "N" PLZN		
NEXT ASSY.	USED ON	DESIGN ENG	XXX	XX/XX/XXXX	SCALE	SUB-DIRECTORY/	
		MFG ENG	XXX	XX/XX/XXXX	3:1	XXXXX	
		ECO APPRV	XXX	XX/XX/XXXX	CAGE CODE	DRAWING NO.	
					30990	OL_J991PPDO35BPAN	
					SIZE	SHEET 1 of 1	
					REV.	X1	