

MATERIAL

- Plate: 316 SST
- Pin: Kovar K94610
- Dielectric: Glass, Borosilicate, Corning 7070
- Interposer and CC: BeCu Alloy C17300
- Dielectric: PEEK
- Insert: 303 SST
- Hdwr: 18-8 SST
- O-ring: Butyl Polymer

FINISH

- Plate and pin
Nickel non-magnetic per ASTM B733,
1.27um [50uin] min over Copper 0.25um
[10uin] min
- Interposer and CC
Gold 1.27um [50uin] min over Copper
2.54um [100uin] min
- Insert and Hdwr
Passivated

ELECTRICAL

- Impedance: 50Ω Nominal
- Frequency range: DC to 20 GHz
- RL: ①
≤ -20dB DC - 6GHz
≤ -15dB 6 - 20GHz
- IL: ≤ -0.26dB
- Insulation Resistance: 5000 MΩ min
- Dielectric Withstanding Voltage: 350 Vrms max
- Working Voltage: 115 Vrms max @ Sea Level

MECHANICAL

- Mating Characteristics:
CoreHC(TM) Interface
- Connector Durability: ≥ 1000 Cycles
- Permeability: <1.1 Mu
- Leak Rate: ≤ 2.0E-09 Torr-L/s
- Cable Assy installation ②

ENVIRONMENTAL

- Temperature Range:
-273°C to +85°C
- Thermal Shock:
MIL-STD-202, Method 107, Test Cond. B
- Moisture Resistance:
MIL-STD-202, Method 106
- Corrosion:
MIL-STD-202, Method 101, Test Condition B
- Vibration:
MIL-STD-202, Method 204, Test Condition B
- Shock:
MIL-STD-202, Method 213, Test Condition I

NOTE(S): UNLESS OTHERWISE SPECIFIED

- ① Tested with TM7S-S-ST28R-8MS015C Cable Assy.
- ② Refer to CoreHC Installation Guide for recommended assembly procedure.
3. See sheet 2 for integration guide.

THE INFORMATION CONTAINED HEREIN IS PROPRIETARY TO AMPHENOL, AND SHALL IN NO WAY BE REPRODUCED OR DISCLOSED IN WHOLE OR IN PART OR USED FOR ANY DESIGN OR MANUFACTURE EXCEPT WHEN SUCH USER POSSESSES DIRECT, WRITTEN AUTHORIZATION FROM AMPHENOL.

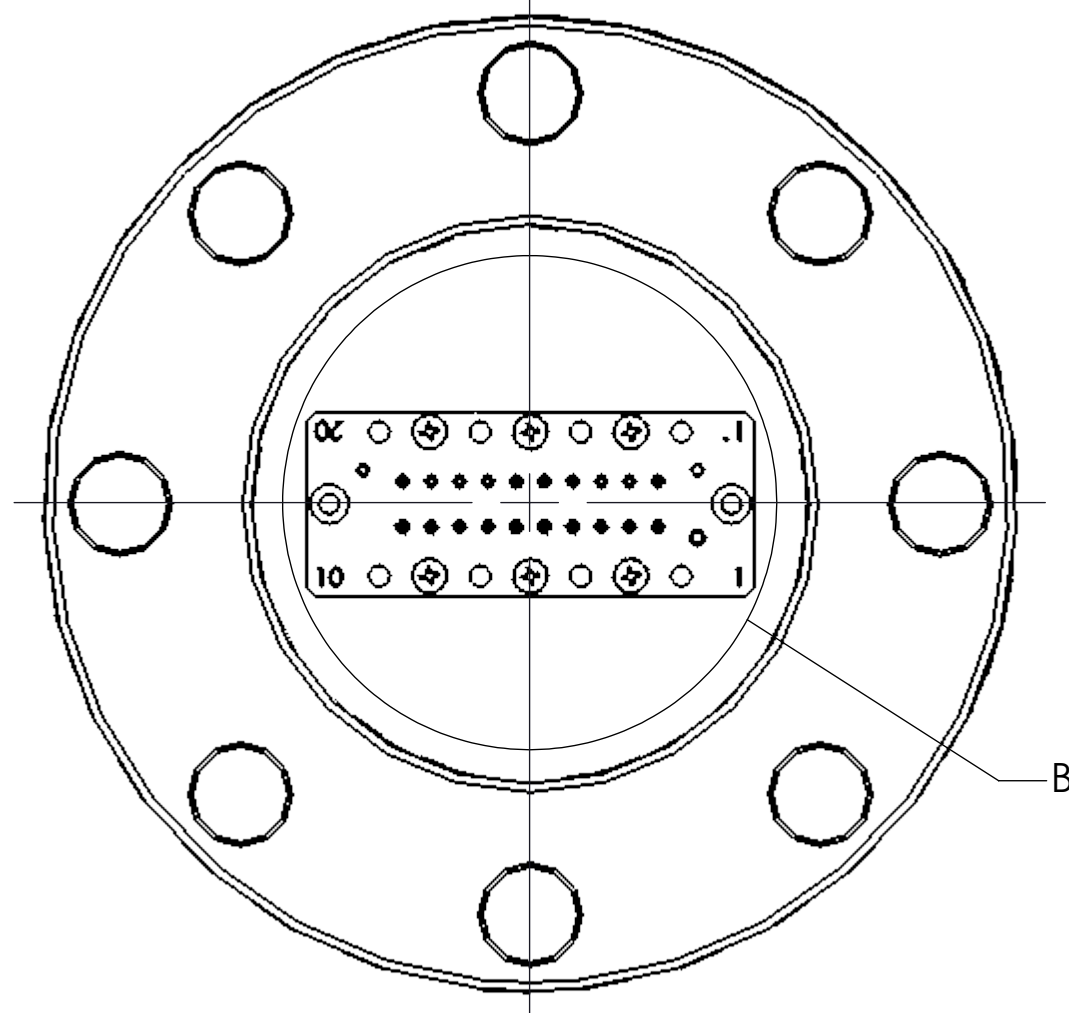
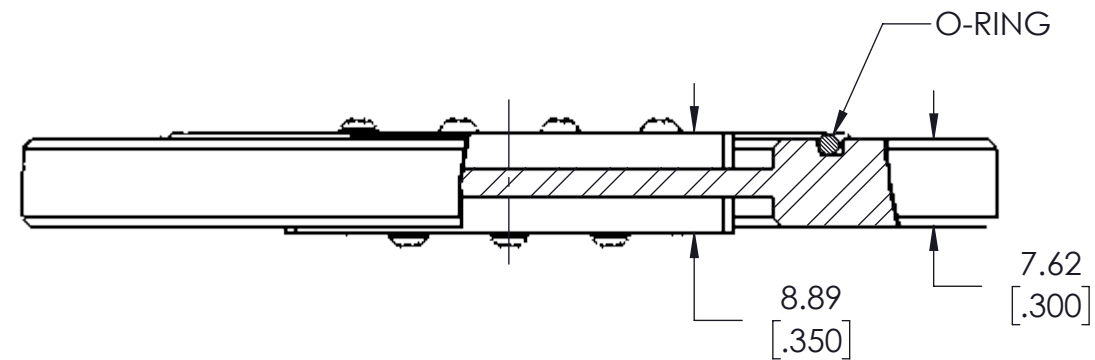
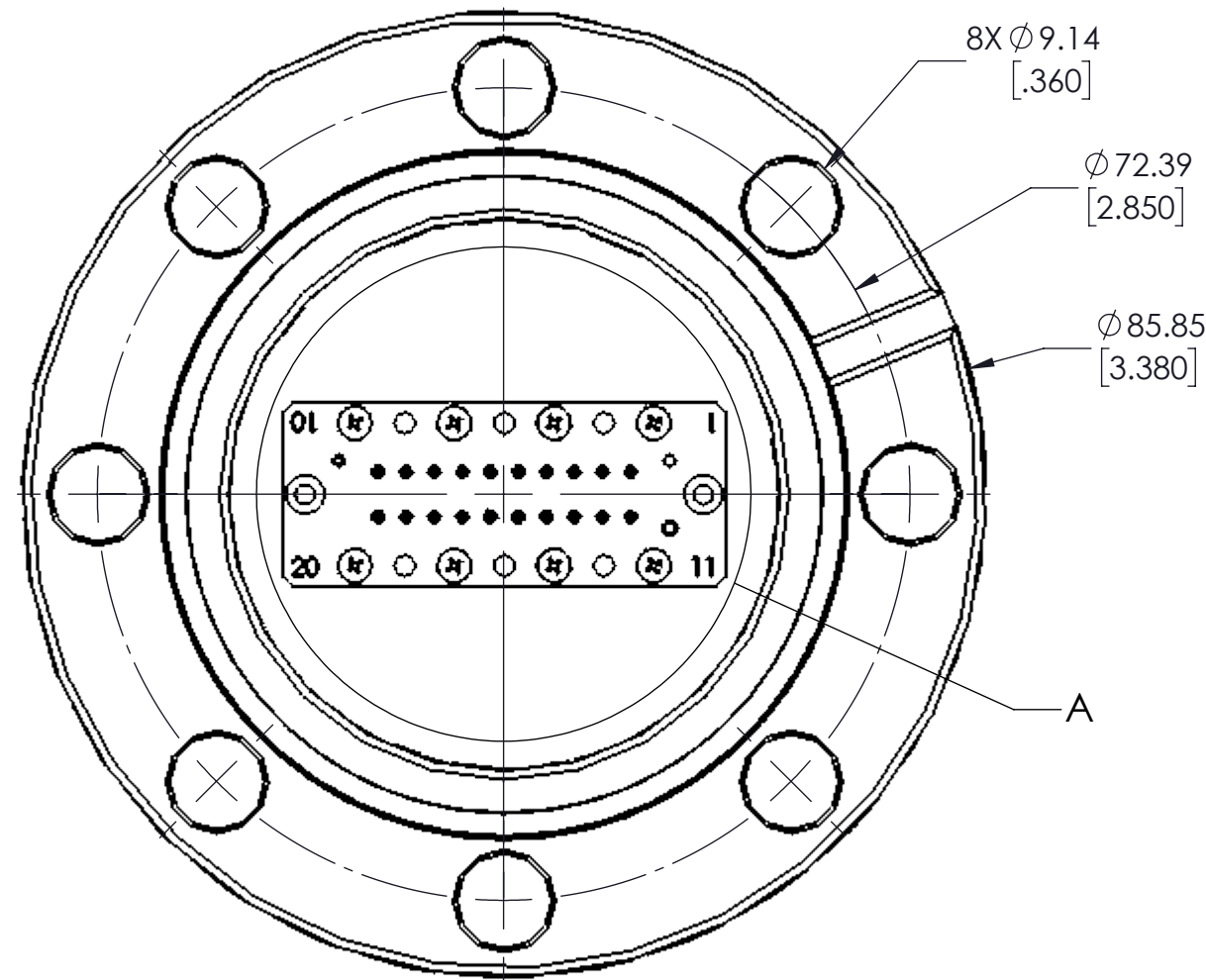

REVISIONS			
REV.	DESCRIPTION	DATE	APPROVED
01	INITIAL RELEASE	05/14/25	PV
02	UPDATED CAGE CODE	6/5/2025	PV

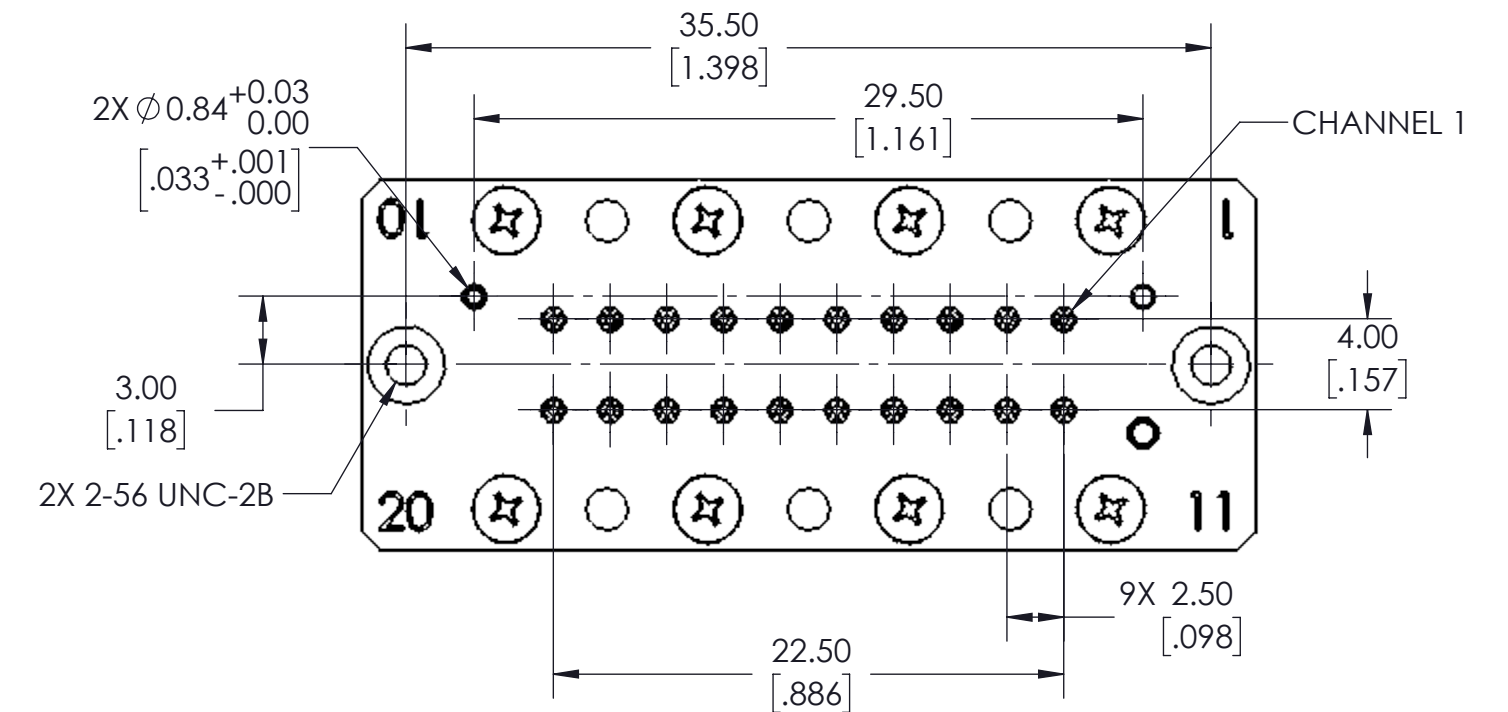
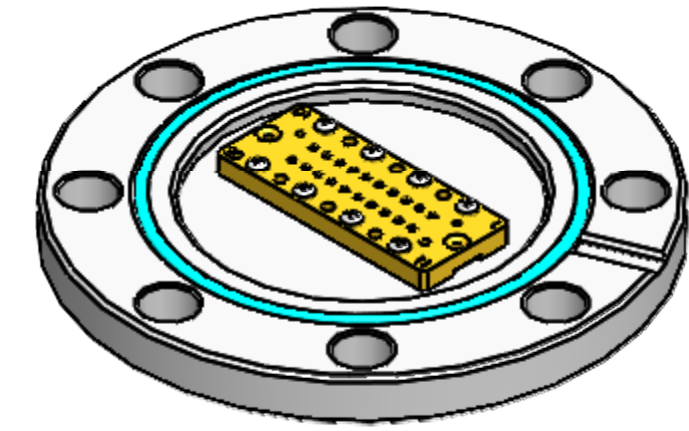

DETAIL A
SCALE 3 : 1

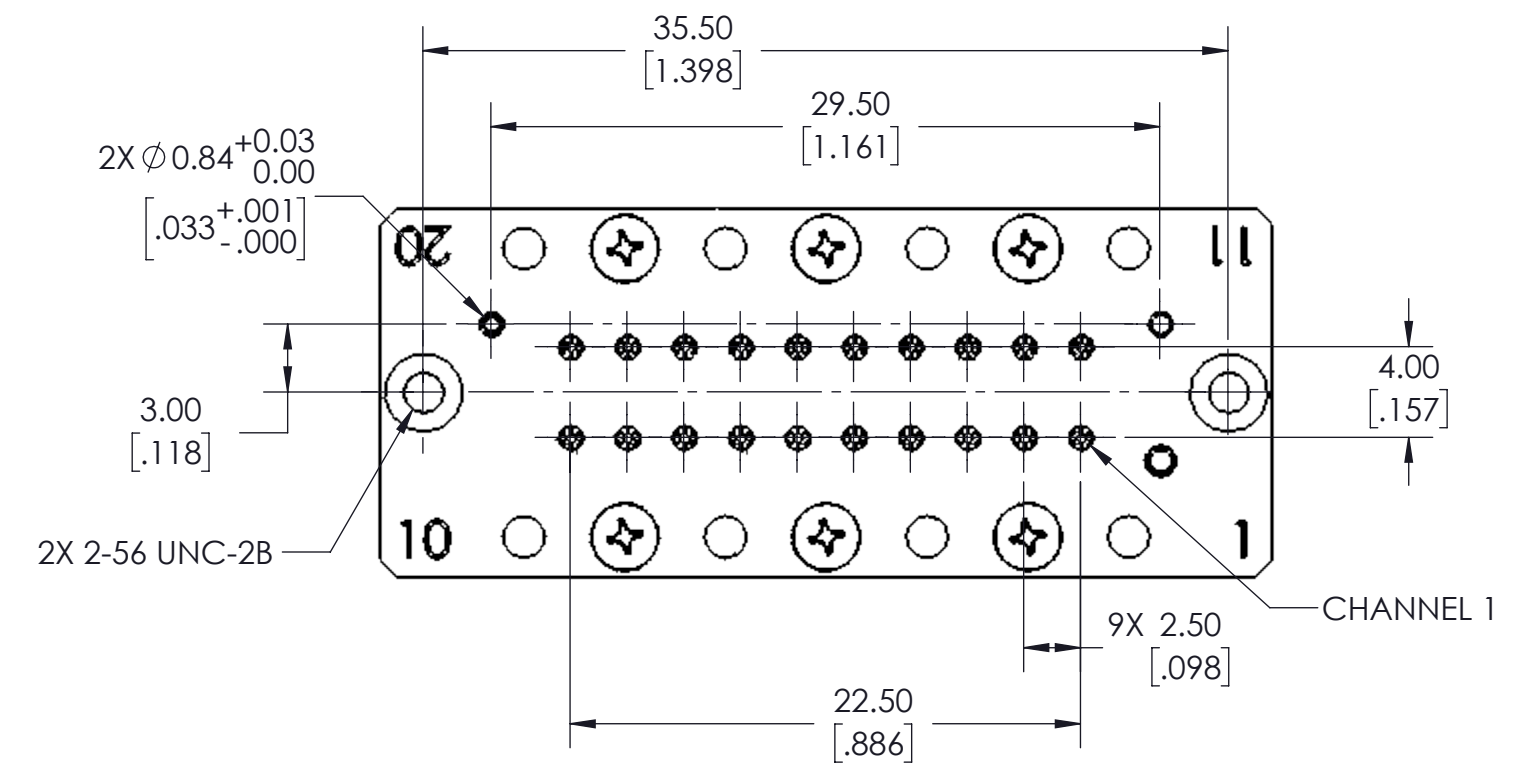

DETAIL B
SCALE 3 : 1

DIMENSIONS ARE IN MILLIMETERS/INCHES ± TOLERANCES UNLESS OTHERWISE NOTED				THIRD ANGLE PROJECTION		Amphenol			
.XXX	.XXXX	ANGLE	FRACTIONS	 DESIGN ENGR: P VOLKOV 04/14/25 DESIGNED BY: P VOLKOV 04/14/25 PRODUCT: QUALITY: MFG:		TITLE Hermetic Plate Assy, CoreHC, 20 Channel			
0.076 [0.003]	0.013 [0.0005]	0.5				SIZE C	CAGE CODE 30990	CARLISLE NUMBER TM50-0129-02	REV 02
NEXT ASSY.		USED ON		APPLICATION		SCALE: 3:2	DO NOT SCALE DRAWING	1 OF 2	



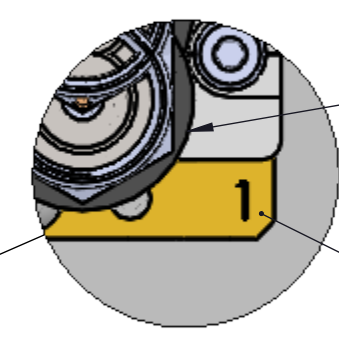
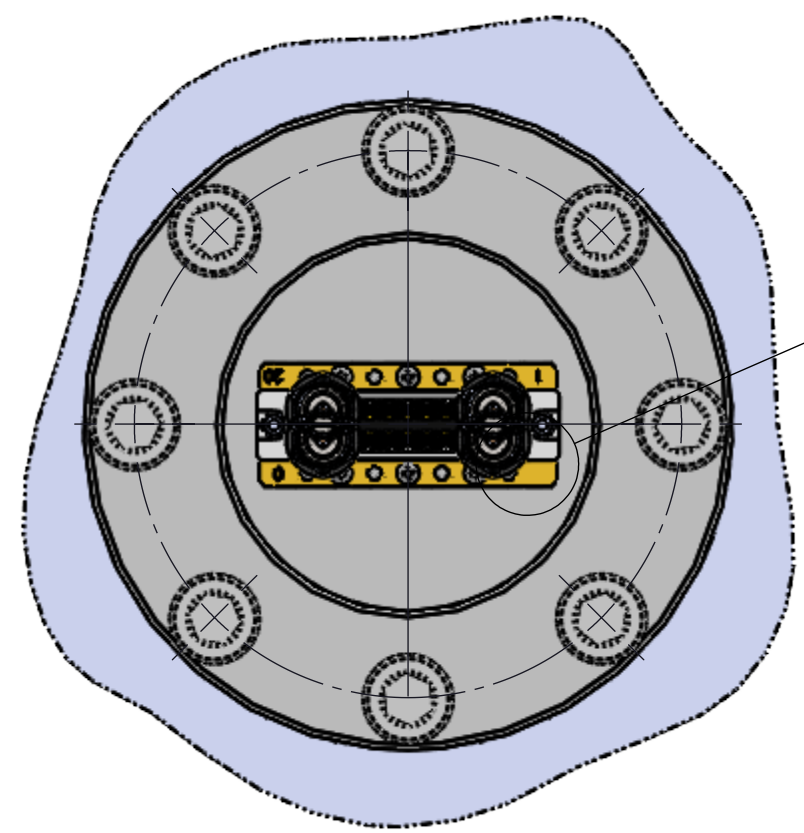

DETAIL C
SCALE 3 : 1

Channel 1
Channel number labelled on hermetic plate

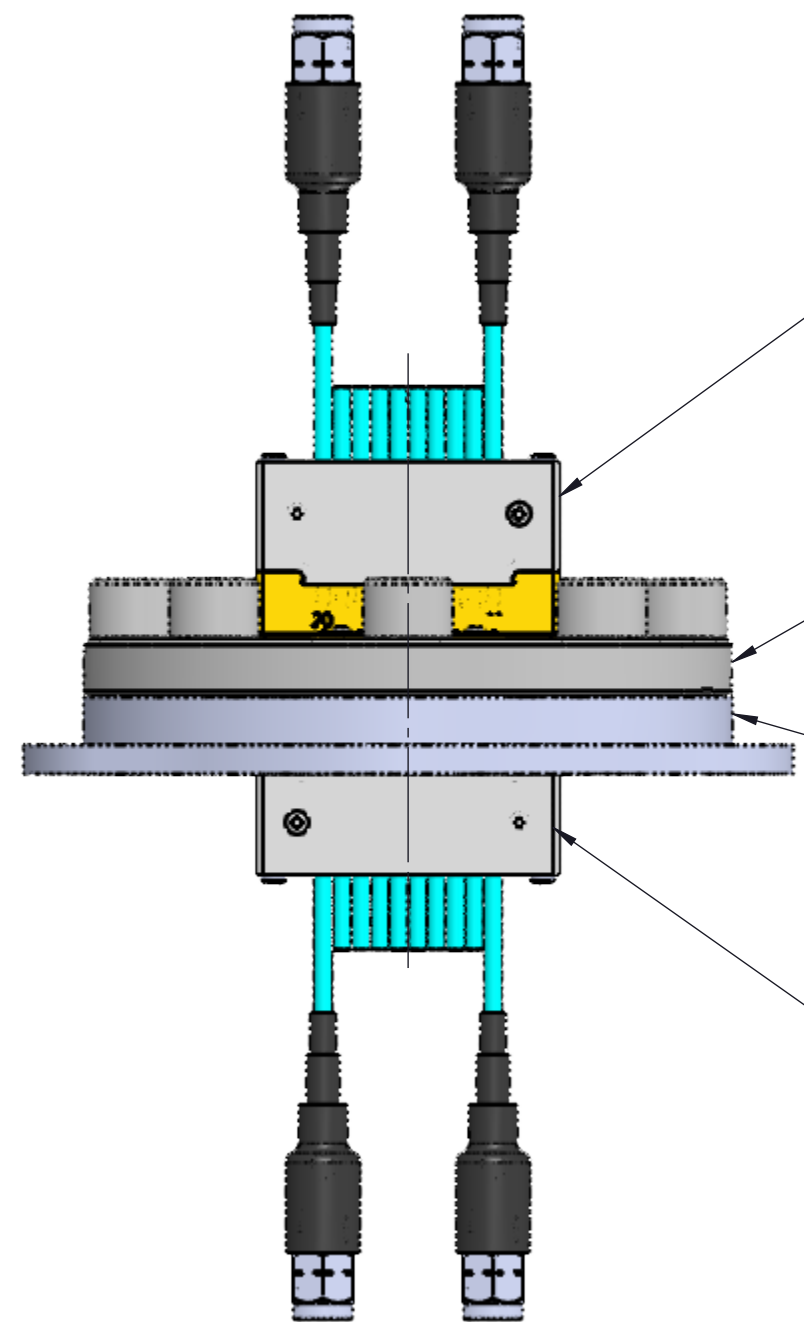

CoreHC Assy
PN: TM7S S DT10R XXX XXX X
ref
②

Hermetic Plate
PN: TM50-0129-02
(described in this document)

Chamber
ref

CoreHC Assy
PN: TM7S S DT10R XXX XXX X
ref
②

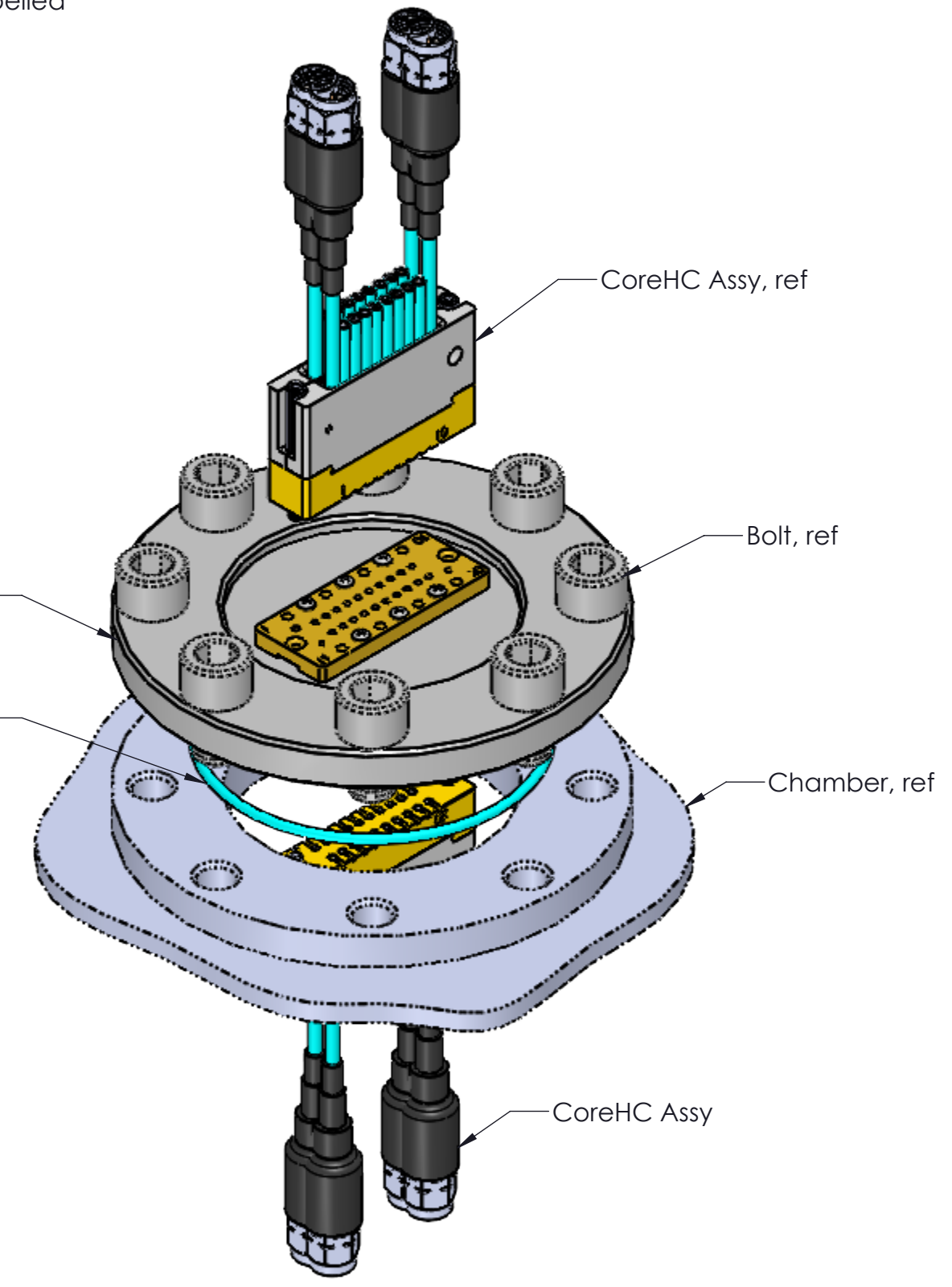

Hermetic Plate
(component in TM50-0129-02,
described in this document)

O-Ring
(component in TM50-0129-02,
described in this document)

CoreHC Assy, ref

Bolt, ref

Chamber, ref

CoreHC Assy



Hermetic Plate Assy,
CoreHC, 20 Channel

SIZE C	CAGE CODE 30990	PART NUMBER TM50-0129-02	REV 02
SCALE: 1:1		2 OF 2	